

M2- UNIPLATE

COMBINE **PUQPRESS M2**
WITH EVEN MORE GRINDERS.

puq[®]
PRESS

precision
coffee
tamper



WHAT'S UP?

PUQPRESS M2 UNDERNEATH YOUR GRINDER

THE M2-UNIPLATE
ENABLES THE
PERFECT TAMPING
SET-UP **FOR YOUR
GRINDER**, WITHOUT
THE NEED FOR EXTRA
COUNTER-SPACE.

PUQPRESS M2

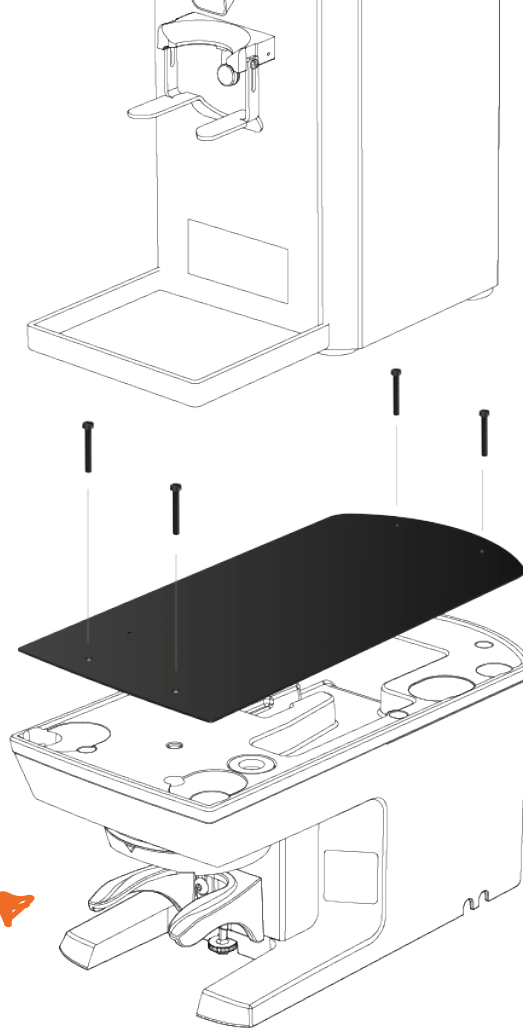

M2-UNIPLATE

Net weight:
0.96 kg

Dimensions (DxWxH):
36.8 x 17 x 0.2 cm

Available colours:
Black, White

WHAT'S NEW?

MATCHING PUQ WITH MORE THAN ONE GRINDER

> GRINDER COMPATIBILITY

Successfully fitted with **Anfim, Markibar** and more.

> NO NEED FOR COUNTER-SPACE

Simply place your grinder on top of the **M2-UNIPLATE** and start serving **consistent coffees with ease**.

YOUR
GRINDER
HERE

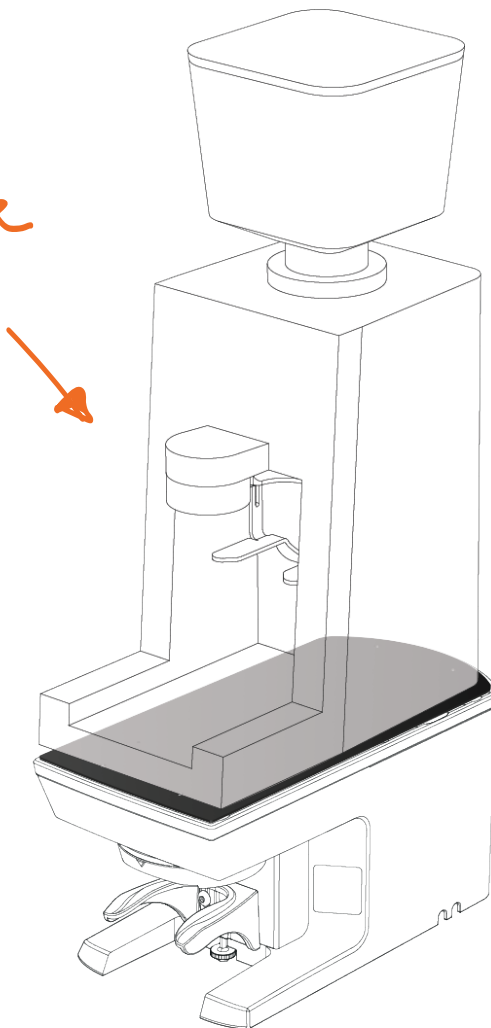



MATCHES MADE IN HEAVEN

Markibar

Izaga & OHRI range

Anfim

Scody, SP II &
Caimano line

Slingshot

Sisma &
Talis line



THE BIG SECRET

CONSISTENT QUALITY MAKES ROOM FOR CREATIVITY

Tamping is an important part of a barista's craft, but doing it by hand hundreds of times a day damages shoulders and wrists. So why not let Puqpress deliver **the perfect tamp** for you?

No strain or pain, more time for creativity, craftsmanship and customers.

IT
WORKS
LIKE

1

2

3

BUT
FASTER



WE HANDLE THE PRESSURE®

puq®
PRESS

precision
coffee
tamper

